

PARLIAMENT

RESOLVED that Parliament in accordance with Section 5 (1)(c) of the Crown Lands (Vesting and Disposal) Act, Cap. 225, approve the lease to the Barbados Conference Services Limited of the parcel of land together with the buildings thereon, situate at Two Mile Hill in the parish of Saint Michael, in this Island more particularly described in the *First Schedule* to this Resolution on the terms and conditions set out in the *Second Schedule* to this Resolution.

APPROVED by the House of Assembly this day of ,
Two thousand and fifteen.

SPEAKER

APPROVED by the Senate this day of , Two
thousand and fifteen.

PRESIDENT

FIRST SCHEDULE

ALL THAT land, the property of the Crown shown and delineated as Section B on the Plan hereinafter referred to, situate at Two Mile Hill in the parish of Saint Michael in this Island containing by admeasurement 9012.4 square metres or thereabouts (inclusive of 722.7 square metres in road) Abutting and Bounding on a public road called Highway 5 which leads to Bridgetown in one direction and to Mapp Hill in the other direction and on another public road and on lands now or formerly of Donald Trotman and on lands now or formerly of the Barbados Diocesan Trustees and on lands now or formerly of National Housing Corporation and on other lands of the Crown or however else the same may abut and bound as shown and delineated on a Plan certified on the 15th day of November, 2011 by Michelle E. ST. Clair, Land Surveyor and recorded in the Lands and Surveys Department on the 1st day of December, 2011 as Plan No. 1233/2011 together with the buildings thereon.

SECOND SCHEDULE

TERMS AND CONDITIONS:

1. The term of the lease shall be for a period of twenty-five (25) years with an option to renew for a further twenty-five (25) years;
2. The rent shall be at the rate of \$100.00 per annum with respect to Parcel B and shall be subject to review every five (5) years;
3. The lessee shall be responsible for:
 - (i) the building and other property maintenance; and
 - (ii) all outgoings including rates and taxes with the exception of property insurance;
4. The lessee shall provide and maintain in effect occupiers liability insurance and any other insurance coverage as reasonably required by the Lessor with the exception of Property Insurance;
5. The lessor shall provide and maintain in effect property insurance with limits not less than 100% of the full replacement cost of the property; and
6. No development is to be carried out without the expressed permission of the landlord.

ADDENDUM

On the 28th day of May, 2015 the Cabinet agreed *inter alia* that 9012.4 square metres of land situate at Two Mile Hill, in the parish of Saint Michael in this Island together with the buildings thereon should be leased to the Barbados Conference Services Limited.

In accordance with section 5 of the *Crown Lands (Vesting and Disposal)* Act, Cap. 225, the approval of Parliament is sought for the lease to Barbados Conference Services Limited of the parcel of land described in the *First Schedule* to this Resolution, subject to the terms and conditions set out in the *Second Schedule* to this Resolution.

LANDS AND SURVEYS DEPARTMENT

Survey Order No: 19/2011
Correspondence No: 0305/83 Vol. 1

Parish of: St. Michael
Locality: Two Mile Hill

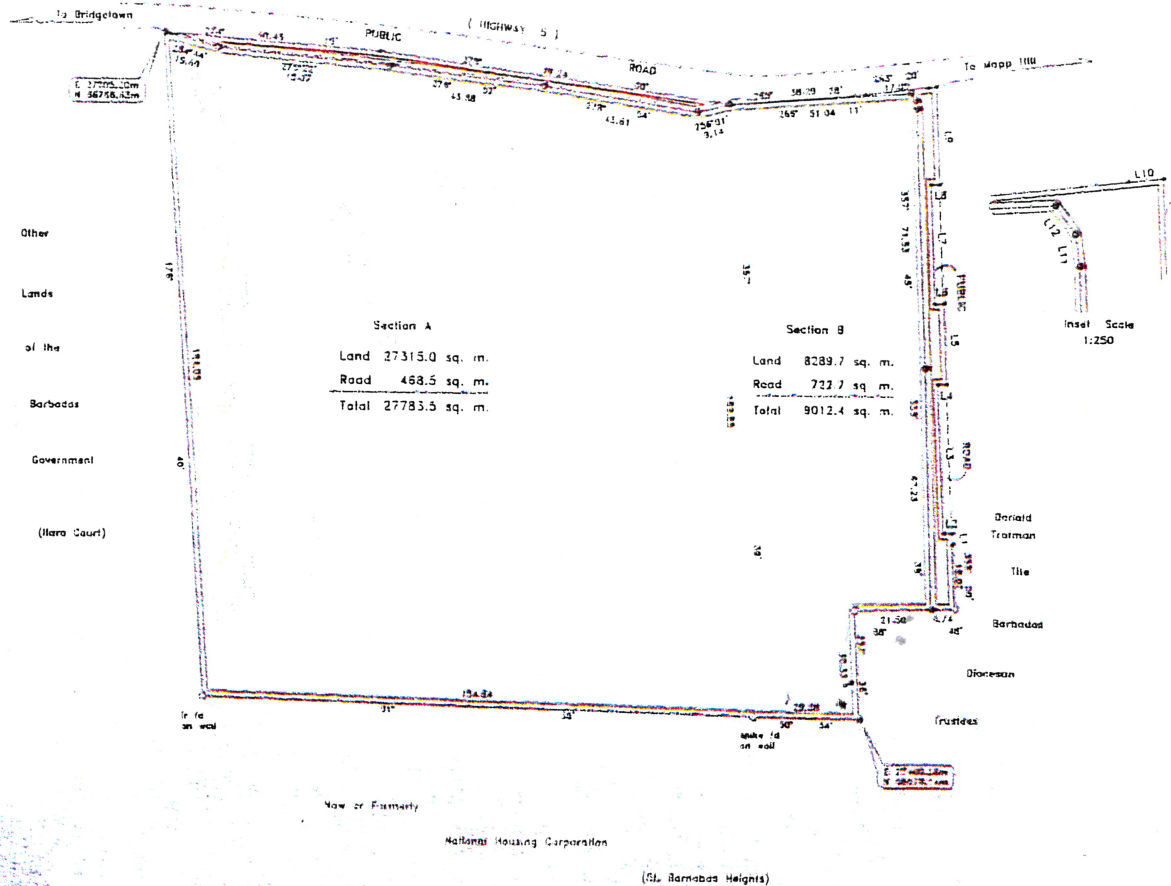

Note:

- (1) Previous survey plans by:
G. L. Jenkins certified 10th September 1987 with D.L.S.# 1041/87 (Section A)
M. S. A. Lucas certified 17th November 1989 with D.L.S.# 1175/89 (Section B)

1	27315.0	27315.0
2	458.5	458.5
3	27783.5	27783.5
4	8289.7	8289.7
5	722.7	722.7
6	9012.4	9012.4
7	27315.0	27315.0
8	458.5	458.5
9	27783.5	27783.5
10	8289.7	8289.7
11	722.7	722.7
12	9012.4	9012.4

Barbados

PLAN OF LAND (bordered green and brown)
at TWO MILE HILL, ST. MICHAEL
containing Land 35604.7 sq. m.
Road 1131.2 sq. m.
Total 36735.9 sq. m. (3.580 Ha)
surveyed for MINISTRY OF HOUSING AND LANDS
Certified 15th November, 2011

MICHELLE E. ST. CLAIR
Land Surveyor

SCALE 1:1000

Distances are in metres
Bearings are referred to Grid North
derived from D.L.S. control T1971
& T1872

- (1) denotes iron found unless otherwise stated
- (2) denotes iron pit
- (3) denotes x rock found
- (4) denotes x pit
- (5) denotes computed point

Land Tax #: 11.02.05.301

For Lands and Surveys Dept only

